

REFER TO LANDSCAPING PLAN FOR DETAILS

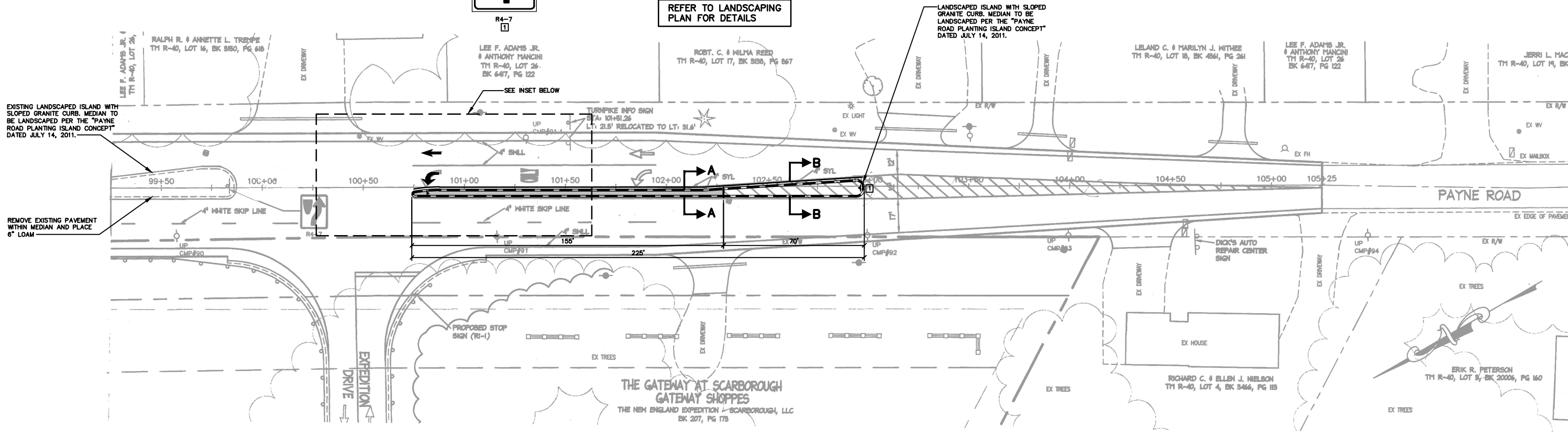

PLAN SCALE: 1"=25'

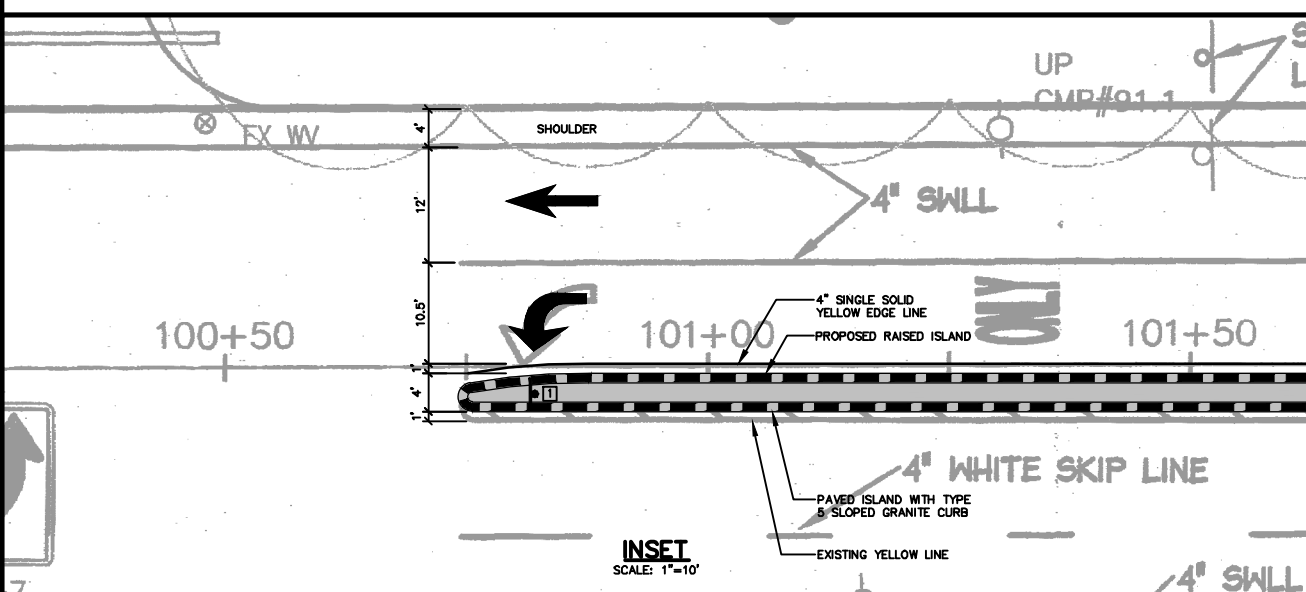

INSET SCALE: 1"=10'

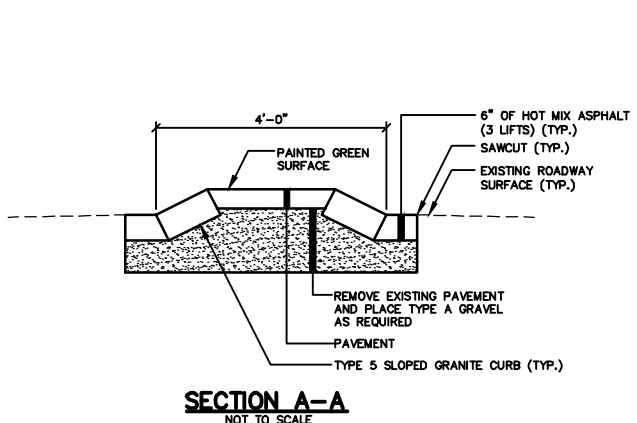

SECTION A-A NOT TO SCALE

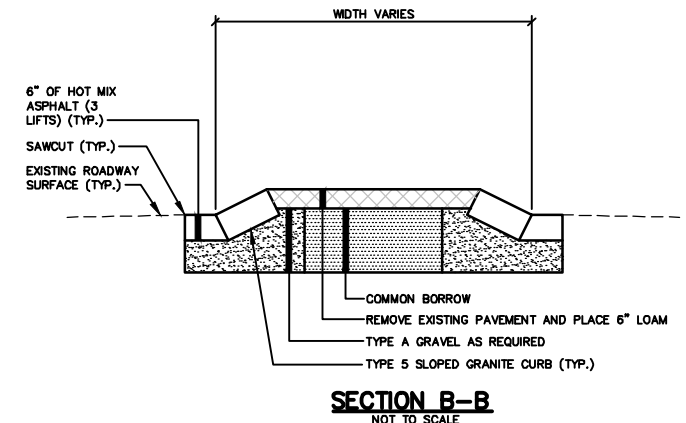

SECTION B-B NOT TO SCALE

BASE PLAN SOURCE:
OEST ASSOCIATES, INC., TITLED "PAYNE ROAD & HAIGIS PARKWAY IMPROVEMENTS", DATED "FEBRUARY 2007", REVISED "6/07/07".

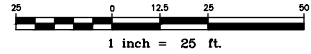

U:\2130-09 - Payne Road Modifications\2 - CAD\DWG\2130-09_phase.dwg 8/18/2011 8:05 AM

Rev.	Date	Revision

Traffic Solutions
235 Bancroft Street, Portland, ME 04102

Design: RED Draft: DB Date: JAN 2010
Checked: TLG Scale: AS SHOWN Job No.: 2130.09
File Name: 2130-09_phase.dwg
This plan shall not be modified without written permission from Gorrill-Palmer Consulting Engineers, Inc. (GPCEI). Any alterations, authorized or otherwise, shall be at the user's sole risk and without liability to GPCEI.

GP Gorrill-Palmer Consulting Engineers, Inc.
Engineering Excellence Since 1998
PO Box 1237 207-657-6910
15 Shaker Road FAX: 207-657-6912
Gray, ME 04039 E-Mail: mailbox@gorrillpalmer.com

Drawing Name: **Payne Road Concept Plan**
Project: **Payne Road Modifications**
Scarborough, Maine
Client: **Town of Scarborough**
259 U.S. Route 1, P.O. Box 360, Scarborough, ME 04070

Drawing No. **1**